

F1-8200A

FEATURES

- Singlemode/Multimode Use
- EIA / TIA specifications
- Low insertion loss
- Compact and lightweight
- Easy installation on panels
- Perfect durability
- Precision alignment straight split sleeves

APPLICATIONS

- Telecommunications
- Local area network
- Fiber optic instruments
- Testing optical devices

SPECIFICATIONS

Optical Characteristics- ST DD-Shape PC

	Singlemode	Multimode
Typical Insertion Loss	.07	.15

Mechanical Characteristics

Insertion Loss variation after 500 connections	< 0.10dB
Corrosion resistant body	

Materials

Dust cap	Vinyl
Body	Nickel Plated Brass
Sleeve	Zirconia
Hexagonal Nut	Nickel Plated Brass
Washer	Nickel Plated Brass

Environmental

Operating Temperature (°C)	.Min -20° to Max +60
----------------------------	----------------------

TECH DRAWING

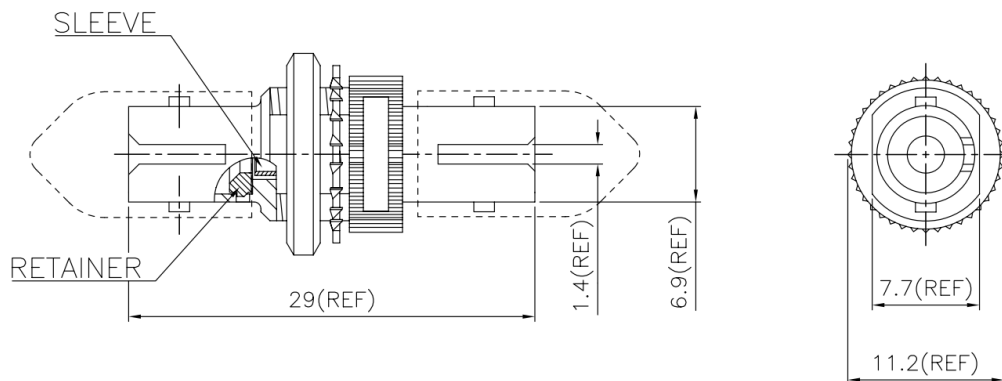

This following drawing shows the dimensions recommended for the panel hole.